

INSTALLATION INSTRUCTION

Model	Product	Code
HONDA Monkey 125	Engine Guard in Silver & black color	EG-HM-S & EG-HM-B

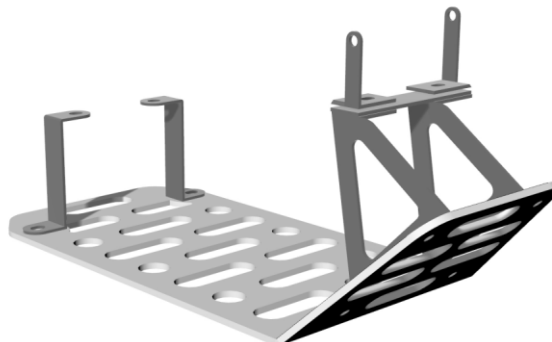
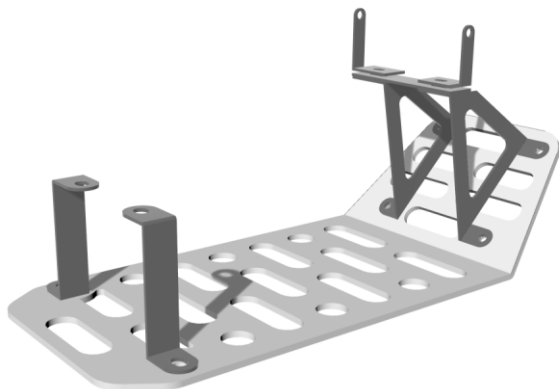

CONTENTS

1. 1pcs Μεταλική βάση αλουμινίου(EG-HM)
2. 7pcs Μεταλικά εξαρτήματα (Σετ L-EG-HM 7pcs)
3. 6pcs Βίδες M6X12 αλεν οβαλ
4. 2pcs βίδες M6X15 αλεν οβαλ
5. 8pcs παξιμάδια ασφαλείας M6
6. 8pcs ροδέλες 6X12

MATERIAL DESCRIPTION

The product is made of:

The central aluminum protective surface 4 mm thick and painted in black or silver color with electrostatic painting (EG-HM-S & EG-HM-B).

The rest of the parts are made of DKP metal 2mm thick and painted black with electrostatic paint.

The screws, nuts, washers and all the rest required for the installation are galvanized in silver color.



These are the contents you will find inside product packaging. Also in the package you will find a card containing the link to download the PDF file with the installation instructions detailed step-by-step with photographic material.

Before starting the installation, read the instructions to have a better idea about the tools you will need and the required skills. Otherwise we suggest to contact a professional.

The product is for race use only

For any further information please do not hesitate to contact us: Tel.: +30 2108075387 Email: info@c-racer.com

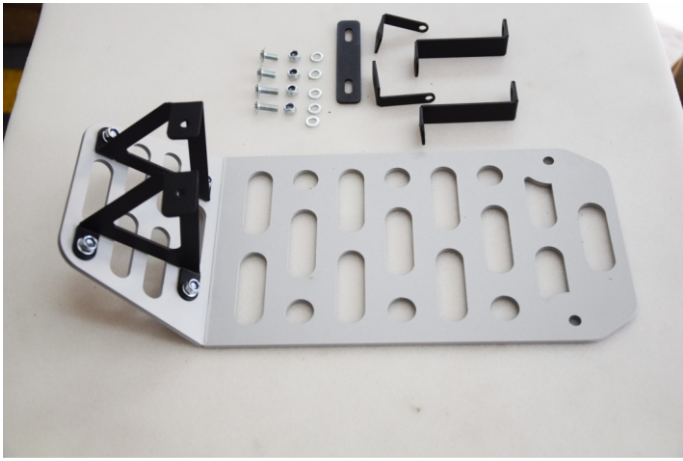

Screw the two support brackets in place as demonstrated.



Don't tighten them, this will be done at the end of the installation.



Remove the two screws on the back of the engine.



With the same screws, install the two supporting brackets as demonstrated. Make sure they are parallel and tighten them.

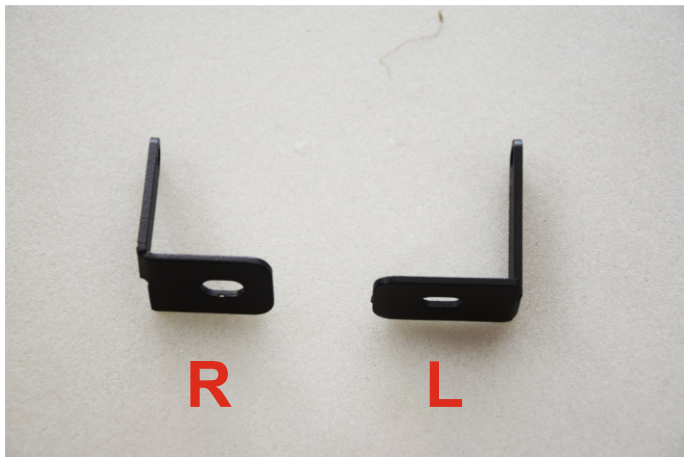

The next things you will place are the brackets shown at the photo. The shorter one is for the right side and the other for the left.

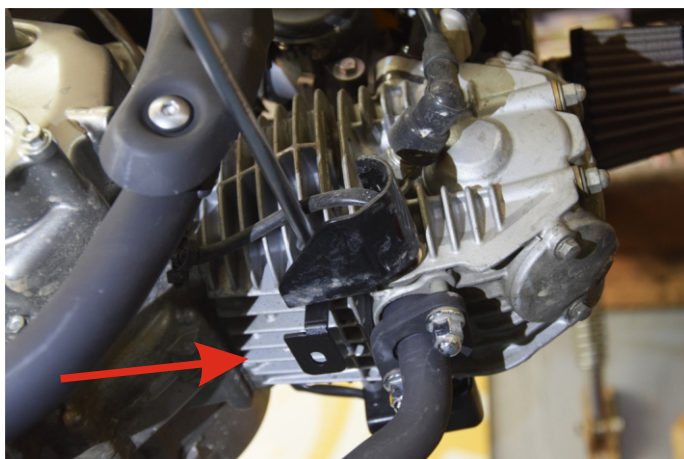

Remove the sensor protector from the right side and insert the relevant bracket from the inside, as shown at the photo. Screw it but do not tighten it yet.

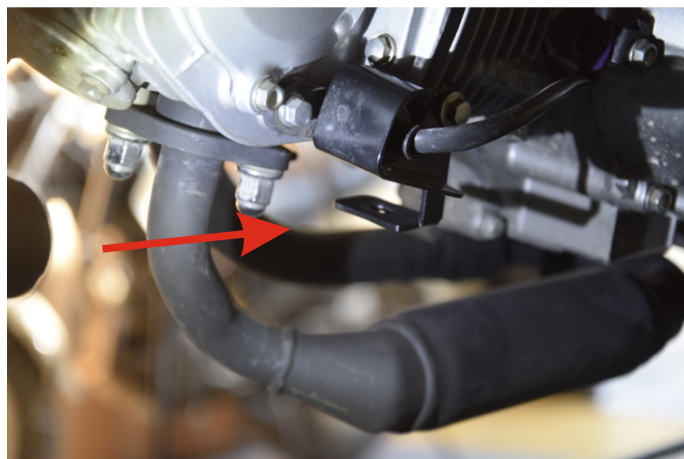

Do the same on the other side. But do not tighten the screws.



Place the rack in place to find exact place.

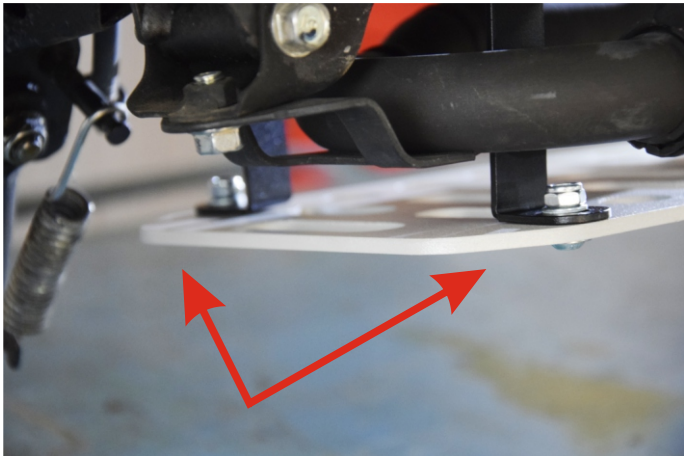

Screw the back of the grill on the brackets you have already placed.

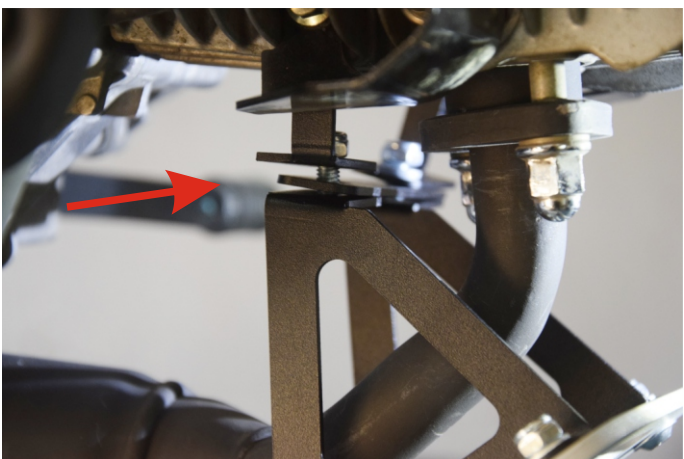

Pass the last bracket between the upper ones you have put on the engine and underneath which are placed on the rack. Here you will use the large screws (M6X15). Now you can tighten them normally.



Finally, tighten all the screws you have put in and the product is ready for use.

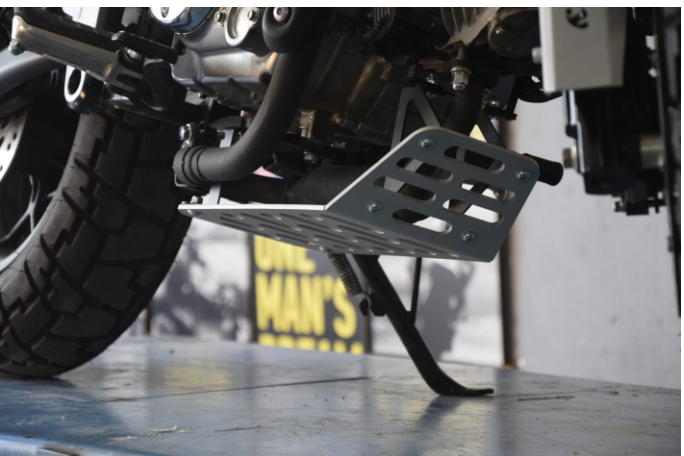

This will be your final result. Enjoy your rides!