



**C-RACER**  
www.c-racer.com

# INSTRUCTION

Page 1/2

Model	Product	Code
KTM 390/290 Adventure	Fender Extender	FE-KTM390ADV-O & W

## CONTENTS

1. 1pcs Plastic Part
2. 2pcs screws M5X15 (allen-round head-washer)
3. 2pcs plastic washers 5X16

FE-KTM390ADV-O



FE-KTM390ADV-W

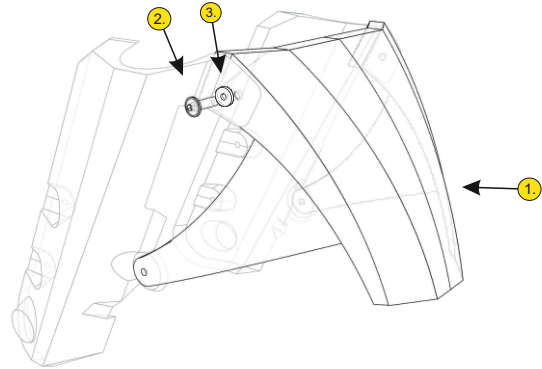

**Basic condition for mounting this product you must first install the two fork guards (FG-KTM390). If these two are not present the product support is insufficient, and we do not recommend.**

After fitting the fork guards, remove the screw behind the fork. Keep it you will need it later.

Put the mudguard in place. at the top it should be through the guards while at the bottom it should be outside. Slide the screws in place and make sure the mudguard is aligned before tightening. Tighten all screws and you are done.

### INSTALLATION OF STICKERS



It is better to be placed by professionals.  
If you think you have the skills, then follow the Instructions.  
Clean the surface very well.

Spray with soap and water lightly all over the surface.  
Remove the protective paper from the sticker and spray this too and place it on the surface.  
Adjust its position so that it is in the center and check its position back and forth.

Once you make sure it is in the right place then start pushing in the center so that it sticks only there.  
Then with a soft spatula start to dispense the water and bubbles to the outside.  
You can heat it very lightly and carefully to help trapped bubbles to go outside.  
When all the water has left the sticker, press very well the edges.  
Wipe it very well and continue with the other pieces.



The result will be what you see in the photo.  
Thank you for choosing our company's products!

The product is for race use only

For any further information please do not hesitate to contact us: Tel.: +30 2108075387 Email: [info@c-racer.com](mailto:info@c-racer.com)