



**C-RACER**  
www.c-racer.com

# INSTRUCTION

Page 1/4

Model	Product	Code
KTM 390/290 Adventure	Number Plate	NP-KTM390ADV

## CONTENTS

1. 1pcs Stable Base
2. 1pcs Rotating Base
3. 2pcs screws M6X15 (allen-round head-washer)
4. 4pcs screws M6X25 (allen-round head-washer)
5. 2pcs screws M4X15 (allen-round head-washer)
6. 10pcs washers 6X18
7. 6pcs safety nuts M6
8. 2pcs washers 4X12
9. 2pcs safety nuts M4
10. 4pcs Cable Ties 160X2.5
11. 4pcs screws M6X15 (cross-round head)

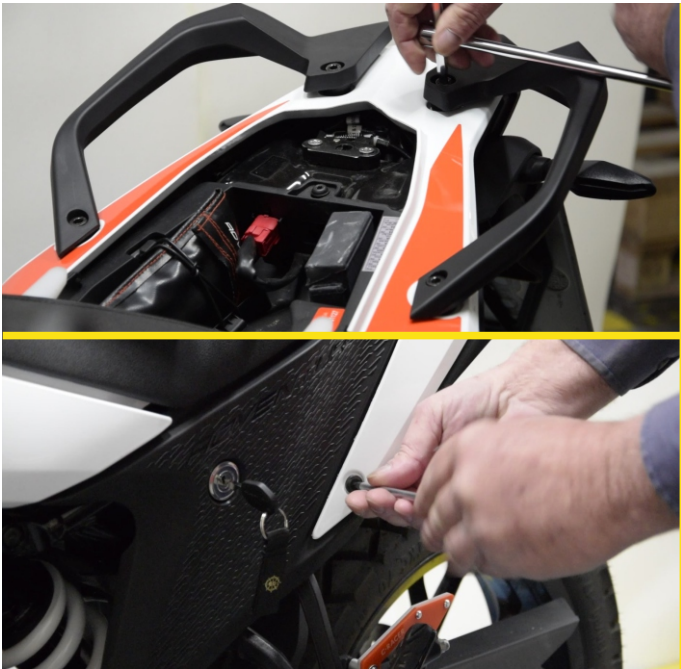
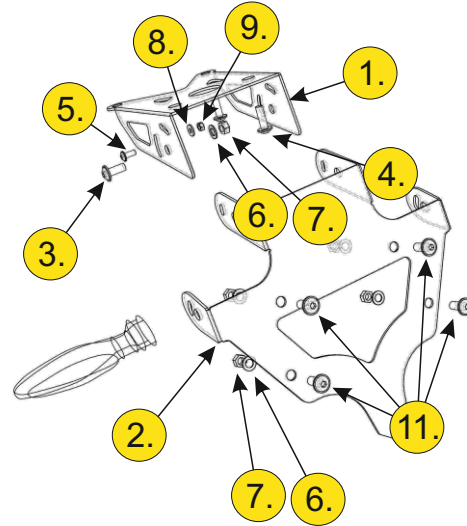

First you must gain access at the flash cable space. Remove the back saddle with the wrench. Unscrew the two handles and after that the two side screws that hold the back cover. To be able to remove it lift it upwards, there are two hooks that hold it so you must remove it alongside.

Check the position of the hooks, so you may put it in his place afterwards.

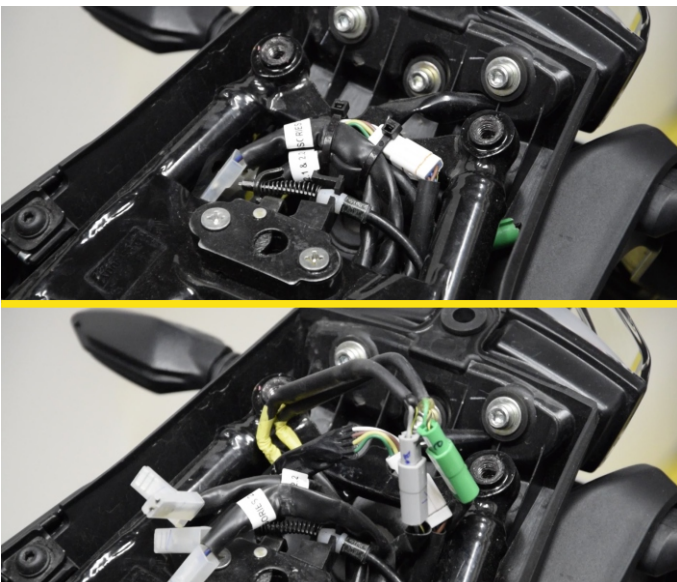

After removing the cover, you will find tied on the subframe a bundle of cables, cut the cable holders, and untangle them.

You will see two cables that from the center go at the below part of the motorcycle through a rubber. The cables have on the other side plugs, a green and a grey. The grey is for the right flash and the green one for the left. You may do a test before removing them.

In case there are different colors, then do the test on your own and find out which color matched the flashes and connect them correctly.

Unplug them so you can release the cables.



Continuing remove the four screws holding the plastic license plate extender spoiler.



The base cannot fall because there are two clips holding it. Move the cables to find the two clips and place your fingers to press evenly.



Push forwards the two clips and at the same time with the other hand push down the whole cover. When it is released, put the cables through the rubber aperture. Do not pull them all at once, they must be pushed through one by one.



After that, turn the base upside down and remove the flash. For the new license plate holder, you may place them again or use any flash you like. Also, regarding the position you will put the plate, you will be able to turn the flash as well, to be horizontal. The side holes are 10 mm diameter in case you use new flash find something that matches. Last also remove the plate above the base, on the same holes you will mount the new base.



Then connect the two pieces of the new base.  
Follow the blueprint, on the first page to use the correct screws.

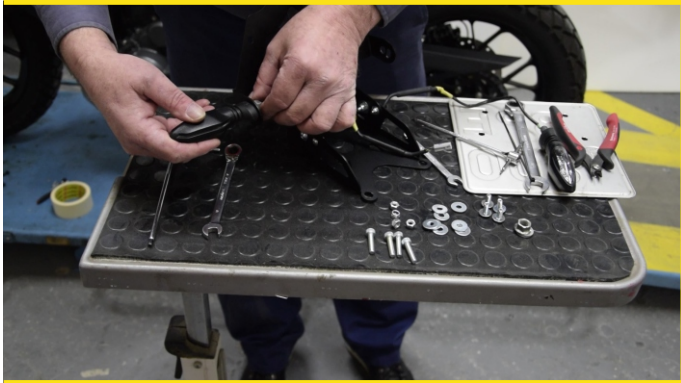

The plate can rotate, so you may place it at the position you prefer.  
Do not tighten it too much, as much as it is needed to be stable. Of course, you may adjust it later.

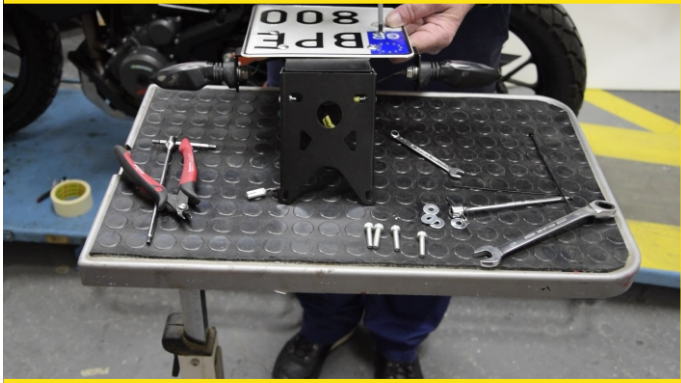

Place the flash and check which is for the left side and which for the right. The grey is for the right and the green for the left.  
Tie the cable at the small hole at the rotating base with a cable holder on each side.

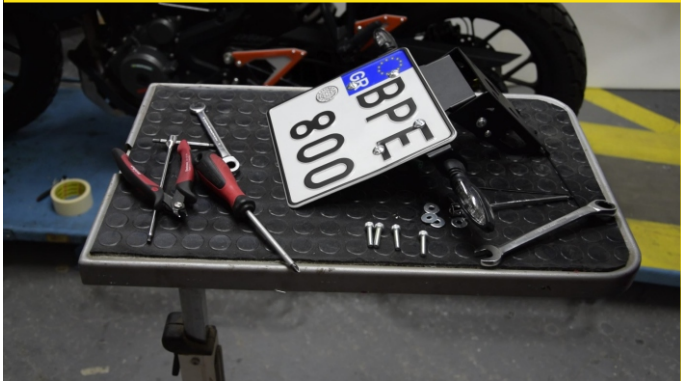

You may place the plate or do it at the end.  
In case you put it now you will see the final result after you do the adjustment.

Now you are ready to place it.



First push the flash cables through the rubber hole one by one and pull them from the above to place it in the correct position.



Then put the screws that hold the plate at the position of the old one. Before you tighten them check the alignment.

Now you may adjust the position of the license plate. Do not forget to turn the lights as well to be horizontal. If you want to turn you license plate upside down, unscrew the small side and loosen the big ones, rotate it and mount the small ones again. This is not indicated from us, because the license plate must always be visible.



Rearrange the cables at their old position and tie them with cable holders at the subframe.

For the end remount the cover and the handles at their position and your job is done!

Thank you for choosing one of our products



The product is for race use only

For any further information please do not hesitate to contact us: Tel.: +30 2108075387 Email: [info@c-racer.com](mailto:info@c-racer.com)